

NEW

Titus New Generation Hinge



T-type Glissando

- 'ConfidentClose'
- '3Way' snap-on
- Low hinge cup depth
- Highly tolerant

Gelmar

T-type Glissando

Titus New Generation Hinge

'ConfidentClose'

*The hinge is designed to provide consumer preferred way of soft closing action

Fast closing

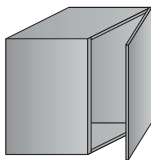

Late start of deceleration action

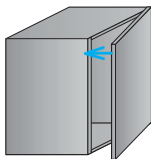

Quiet landing with 'SoftTouch'

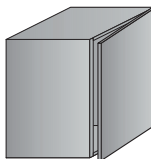

'Titus Damper Inside'

- Titus proprietary multi-purpose damping technology
- Reliable and consistent life-long damping
- No rebound

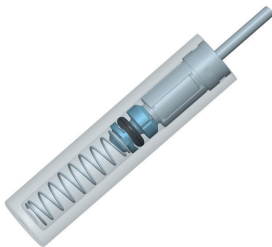

Proven Glissando concept of soft closing in the hinge cup

- Damper is positioned transversal on the hinge cup.
- Reliable performance



Highly tolerant

Efficient performance in marginal values of tolerance

- Reliable door closing in case of accidental misalignment
- 'ConfidentClose' assured

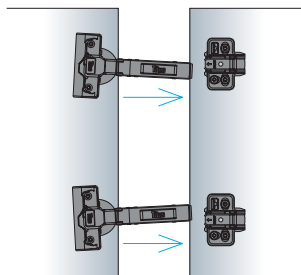

Reliability

- Consistent performance on door of different sizes and weights
- Life-time service

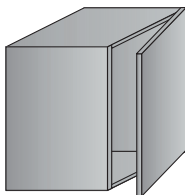

Rigidity

- Hinge-to-plate attachment assures stability and rigidity
- Smooth performance

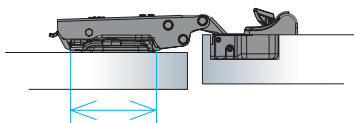

Low hinge cup drilling depth

Enables application on door thicknesses from 15mm on

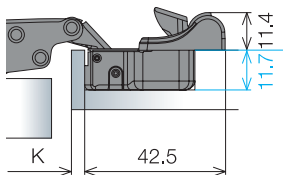

Adjustable damping

- Consistent performance on doors of different dimensions and weights
- Intuitive adjustment procedure

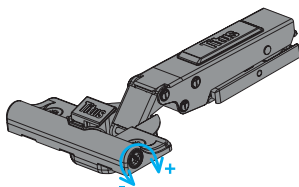

‘3Way’ snap-on

- Allows for intuitive hinge-to-plate mounting in three directions
- Enhanced mounting experience

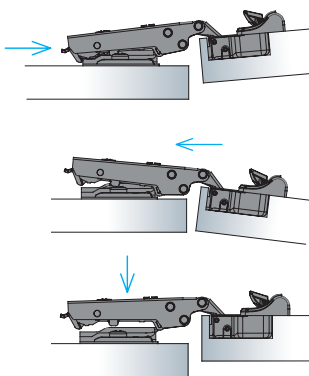

Easy door installation even
in cases of 4-5 hinges per
door



Cam adjustable mounting plates

Linear and cruciform mounting plates

- Easily accessible height adjustment with cam
- Consumer friendly hinge-to-plate attachment
- Improved hinge alignment and performance

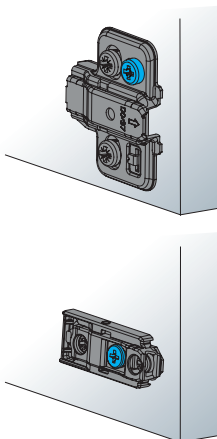

Sleek design

- 3rd Deneration Glissando style
- Form follows function



Precise door alignment

Side adjustment
+3/-1mm



Height adjustment
+2/-2mm

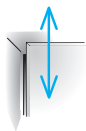

Depth adjustment
+4/-1mm



Technical details

T-type Glissando

| | |
|----------------------------|---|
| Opening angle | 110°, 120°, 170° |
| Hinge cup drilling depth | 11,7mm |
| Hinge cup drilling pattern | 45/9.5mm, 48/6mm |
| Hinge constant | 13mm |
| Door Tab K. | 3-6mm |
| Maximum overlay | 20mm |
| Fixing | screw-on, euro screws, wood screws, dowels for machine insertion, expando dowels, 'EasyFix' |

'3Way' mounting plate

| | |
|--------|--|
| Type | cruciform, linear |
| Height | 0-1-2-3-4mm |
| Fixing | screw-on, euro screws, wood screws, dowels for machine insertion, expando dowels |
